

## Thanks to the following

### T.Y. Residency Documentary

The documentary traces the project through its different stages, looking at the progression of the artworks and talking to some of the students involved.

Produced by:  
Ian Grant  
Conor Miggan

### Exhibition Committee

#### 6<sup>th</sup> Years:

Andrew Walsh  
Manus Goan  
Aisling Fox  
Hazel Ivers  
Ariella Huff

#### 5<sup>th</sup> Years:

Jennifer Twyford  
Kim D'Arcy  
Aaron Rogan  
Bryan Harris  
Ben Sweeney

Painters: Colman Hanley, Lee Caplin, Alex Fingleton, Barry Swaine, Eden Greenberg, Rory Comiskey, Joseph Keeling

### Student Council Art Competition

Janet Murphy (Prefect)  
Winners: Dearbhail Flanagan &  
Pamela Laird

### Photography & Camerawork

Spela Zorko  
Esther Tweig

### Transition Year Books

#### School Book:

Alex Delogu  
Leanne Flynn  
Richard Mulholland  
Conor O'Byrne  
Jennifer Murphy

#### Artist Book:

Spela Zorko  
Jason Druker  
Ian Grant  
Eoghan Walsh  
Caroline O'Loughlin

#### Students Book:

Esther Tweig  
Conor Miggan  
Lorna Dunne  
Yaron Shulman  
Oxana Bazoulkova

### Special Thanks

Tanya Twyford Troy - Art Teacher  
Ms. G Oman – Film Studies  
Ms. Kenny – History of Stratford College  
Mr. Giblin/ Ms. Kenny – The Role of the President  
Rabbi Lent/ Rabbi Newman – Jewish Studies  
Ariella Huff – Programme design  
Elliot Moriarty - Programme support

## Stratford College Golden Jubilee Art Exhibition

### Programme The Face of Stratford

Guest of Honour:  
Mary McAleese, President of Ireland

December 11<sup>th</sup> 2002



## Programme

Arrival of President Mary McAleese at main entrance **11.30am**

Welcomed by:

Mr Alan Green (Chairperson of Trustees of Stratford College)

Mr Adrian Gordon (Chairperson of the Board of Management)

Ms Patricia Gordon (Principal)

Ms Claire Hanrahan (Chairperson of the Student Council)

Tour of exhibition with Mrs. Tanya Twyford Troy (Art Teacher)  
and Christopher Banahan (Artist-in-Residence )

Entrance of President McAleese to School Hall **11.45am**

Opening address: Mr Alan Green

**Address: Mary McAleese, President of Ireland**

Student address: Ariella Huff

Closing address: Mr Adrian Gordon

Presentation of painting by Kate Stitt (2<sup>nd</sup> Year) **12.00pm**

Departure of President McAleese **12.15pm**

Departure of students through School Hall entrance **12.20pm**

Tour of Art Exhibition by invited guests. **12.25pm**

## Reception

## The Art Room Exhibition

### The Artist-in-Residence Experience.

Students from all classes have contributed work to the exhibition. Each class worked on a different element of Christopher's work, the genre of portraiture remaining the centrepiece of the module. As far as possible students entered into the world of the Artist through the experience of different media or even by witnessing the evolution of the pieces by working in the same space as Christopher. The atmosphere on the room was very much one of a studio as opposed to a classroom.

### The Students' Work

The work of the First Years is based on the theme of artefacts with each student designing his or her own "coin". The Second Years explored portraiture and its three-dimensional element through collages focusing on light and shade. Both of these classes also created their own symbols with Chris Banahan's direction. The Transition Year hand-made "books" examine the three different aspects of the exhibition – the school, the students and the artist – using visual imagery and traditional techniques. The large portraits, painted by the Fifth Year Art students, explore the theme of emotions and expressions as portrayed by various artists. The Sixth Years have completed a number of different projects during the year and the best of these will be on display; primarily prints and life drawings. Both Fifth and Sixth Years contributed symbols of their own design, using Chris's techniques.

# Artist-in-Residence Christopher Banahan

Born in Nottingham to Irish parents, Christopher Banahan received a First Class Honours degree in Fine Arts at Trent University in 1981. He went on to obtain an MA in Fine Arts from Goldsmith's College in London, and became a Rome Scholar in the British School of Rome in 1990.

Much of his work is influenced by his studies in Rome. His distinctive style derives from that of ancient Roman frescoes, such as those found in Pompeii. Chris's paintings have a unique "aged" look, brought about by the unusual techniques he employs in his artwork. These techniques can be clearly seen in the portraits of both students and teachers on which he worked for eight weeks and on the panels influenced by classical Hebrew manuscripts.

The portraits have a particular relevance to the Jubilee celebrations of Stratford College, in that they enable the students of today to reflect on the present and the students of tomorrow to reflect on the past.



Main Hall  
Student Council Art Competition



Middle Floor  
The Centrepiece of the exhibition: Portraits of Students of Stratford College



Bottom Floor  
Exhibition works relating to Jewish themes can be found on the bottom floor, on the wall across from the 6<sup>th</sup> Year classroom, with some student works and symbols.

A display of posters and other Jewish works can be found in the reading room, off the Library.



Art Room  
A selection of student work from all years (excluding 3<sup>rd</sup>) is on display in the Art room.



### Top Floor

Portraits of students and teachers from the Arts Department  
Film Studies Documentary on view in the 3rd Year classroom.  
“Reflections”: A selection of writing in the 5<sup>th</sup> Year classroom

### Floor Plan

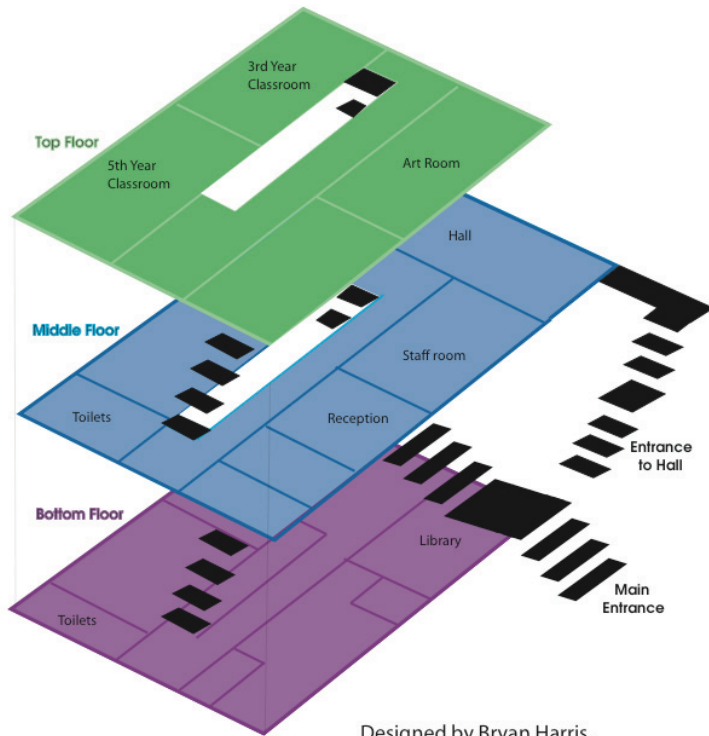

# Stratford College's 50<sup>th</sup> Anniversary

Founded in the early 1950's by leading members of the Jewish community, Stratford College began its life in "Stratford House" on Terenure Road East. The school was founded with the intention of providing secondary education for Jewish children. In 1978 the school opened its doors to students of all denominations. In 1983 a new building was erected behind the school's old façade.

Today, Stratford College is home to 160 students. Its small size makes it an intimate community where students can avail of a high level of personal attention. A wide curriculum is offered and extra-curricular activities such as basketball, tennis, music, photography, debating and drama are provided.

The 50<sup>th</sup> Anniversary celebrations are centred on the theme of Art in Stratford. Earlier in the year, a commemorative assembly was held at which Mrs Elaine Feldman, one of the school's founders, spoke eloquently, and a number of past pupils and prominent members of the Jewish community and the wider school community were in attendance. In early December, the Dublin Talmud Torah sponsored a Kiddush after the Sabbath morning service in Terenure Synagogue.